

# Combo DB15 LCD Console Drawers – High Resolution

Optimize rack space. Maximize rack monitoring



## Optional Remote IP Access

- An expansion slot allows you to add an optional KVM over IP module to enable remote access to your servers.
- Gain BIOS level access to your servers for system maintenance, support or failure recovery via secure SSL authentication and encryption.

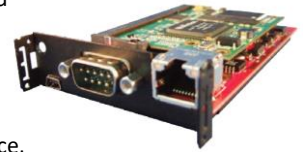

The Anso range of LCD console drawers provides a variety of features that simplify to access servers to making system monitoring, troubleshooting and software upgrades.

The self-locking rails when in the fully extended open position and the ultra-convenient auto lock release when the LCD panel is closed, make for simple and hassle free operation.

Available with 17.3" A-Grade LCD panels, combo DB15 single, 8 or 16 port integrated KVM switch & with an option remote IP console.

## Features

- Support combo interface, VGA-USB & VGA-PS/2.
- Durable 104-key keyboard and touch pad.
- Quick and simple installation.
- Self-locking and auto release rails for ultra-convenience.
- Port selection via push buttons or On-Screen-Display (OSD).
- Dedicated daisy chain port to expand up to 240 servers.
- Access Control List (ACL) security function for up to 8 independent user accounts.

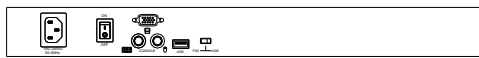

Rear of KVM-1701W-AST-M2

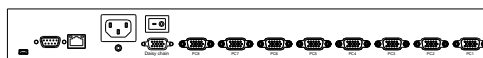

Rear of KVM-1708W-AST-M2

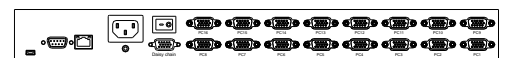

Rear of KVM-1716W-AST-M2

Part No.	KVM-1701W-AST-M2	KVM-1708W-AST-M2	KVM-1716W-AST-M2
Direct no. of Computers	1	8	16
Maximum no. of Computers	1	232(Daisy Chain)	240(Daisy chain)
LCD	Size	17.3"	
	Backlight	LED	
	Resolution	1920*1080 Full HD ( support resolution up to 1920x1200 )	
	Max. color	262K	
	Luminance	300cd/m2	
	View Angel (H/V)	140 / 120	
	Contrast Ratio	3000 : 1	
Port Selection	N/A	Push Button, OSD or Hotkey	N/A
Expansion Slot	N/A	Yes, option for Remote IP Access	N/A
KB/Mouse Emulation	USB & PS2		
Rack Depth	500mm to 1100mm ( rack cabinet front rails to rear rails )		
Power	100-240V AC 50/60Hz via IEC Type power cord		
Environment	Operation temp: 0 to 50°C Storage temp: -20 to 60°C Humidity: 10% - 90%, non-condensing Shock: 10G acceleration ( 11ms duration) Vibration: 17 to 500Hz 1G PTP		
Physical Dimensions / Net Weights	448x42x580mm (WxHxD) / 12.0KG	448x42x580mm (WxHxD) / 12.5KG	
Packing Dimensions / Gross weights	715x140x780mm (WxHxD) / 18.0KG	715x140x780mm (WxHxD) / 19KG	
<b>Accessory</b>			
1.8meter IEC Type Power Cord (1.8meter VGA& PS2Cable + 1.8meter USB A Type Cable for KVM-1701W-AST-M2 )			
<b>Option Relate Item</b>			
CVU-018	1.8meter 2-in-1 KVM Cable-USB&VGA	CVP-018	1.8meter 3-in-1 KVM Cable-PS/2&VGA
CVU-030	3.0meter 2-in-1 KVM Cable-USB&VGA	CVP-030	3.0meter 3-in-1 KVM Cable-PS/2&VGA
CVU-050	5.0meter 2-in-1 KVM Cable-USB&VGA	CVP-050	5.0meter 3-in-1 KVM Cable-PS/2&VGA
DIP-101	KVM over IP module for Remote Bios Level Access		

Specifications subject to change without notice

# Combo DB15 LCD Console Drawers – High Resolution

Optimize rack space. Maximize rack monitoring

Rear of KVM-1701W-AST-M2



Rear of KVM-1708W-AST-M2

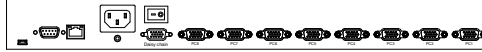

Rear of KVM-1716W-AST-M2

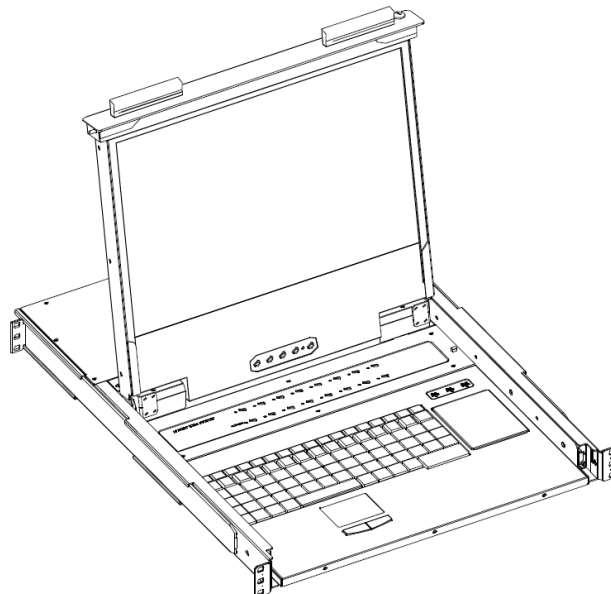
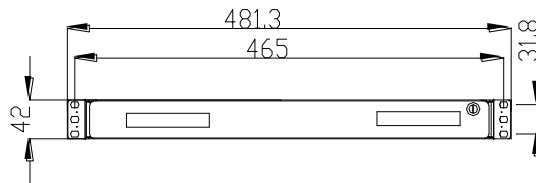
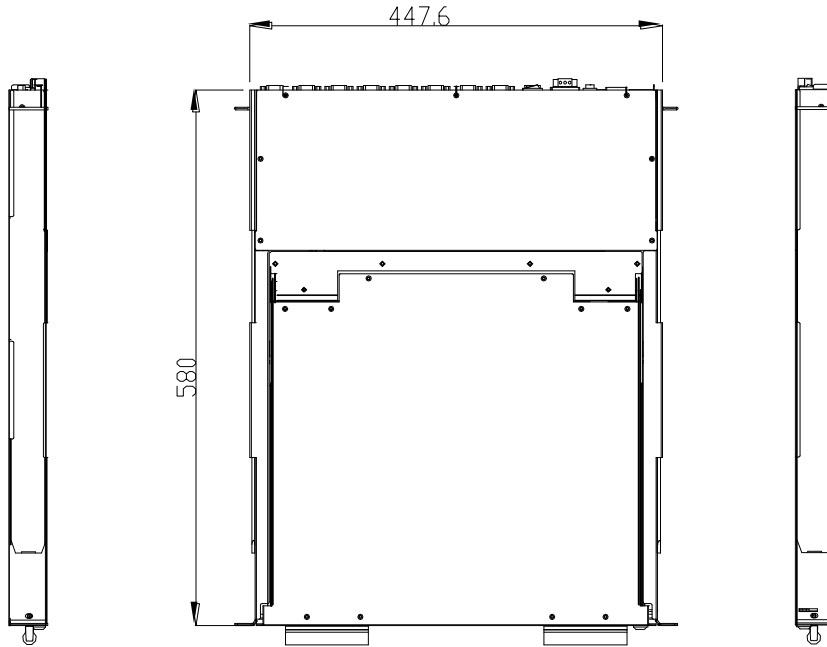
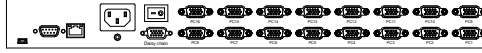

USA (Head Quarter)  
Denichi Computer Devices, Inc.  
13200 Pond Springs Rd. #A102, Austin, TX 78729  
Office: 512-837-2655  
Fax: 512-837-1694  
Email: sales@denichi.com

China (Factory)  
Add : The south faces industry area of Xia Gang Fu Hai road, Chang'an Town, Dongguan City, Guangdong, China  
Email: sales@denichi.com